

PROJECT SHEET

PARK RISE APARTMENTS



LOCATION Altona St
Kensington, VIC

ARCHITECT Rothe Lowman Architects

BUILDER Becton Corporation

INSTALLER Precedent Insulated
Panels

APPLICATION Facade and fire rated
spandrel

The Park Rise apartment complex is a stunning example of the versatility of the Paroc Panel System from CSR Panel Systems.

Designed by Rothe Lowman Architects the exterior includes a range of different materials and windows with which the Paroc Panels interact to create a strong but lightweight facade that compliments the surroundings.



PANEL SYSTEMS



According to Rothe Lowman the Paroc Panels were specified on this project primarily due to their attractive steel finish and fire resistance. When installed vertically the 7.5m - 10.5m long panels fixed at 3m intervals achieve the 1-hour fire rating required at the spandrel level between floors.

In addition, they were selected over alternatives due to CSR Panels System's superior technical support and their speed of installation so reducing overall building costs.

Becton Corporation is the building contractor on the Park Rise project. Site Manager, Rick Jones has been happy with his first experience with Paroc Panels. "We've found Paroc Panels good to work withthe technical support from CSR has been great and I've been impressed with the speed of installation.... I'd be happy to work with them again."

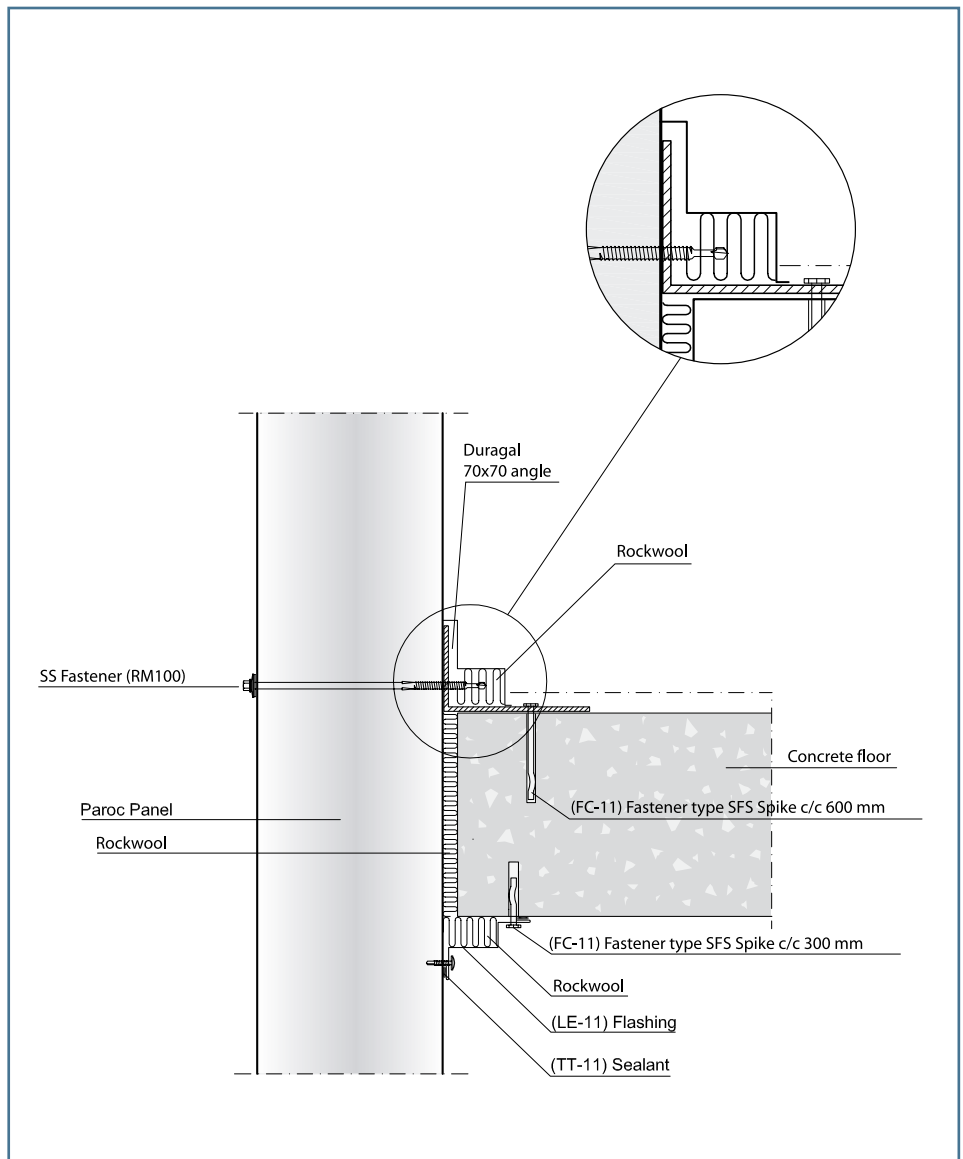

No.PS01



PANEL SYSTEMS

For further information call 1800 023 360

Or visit www.csr.com.au/panelsystems