

LOCATION IKEA, Adelaide Airport,
South Australia

ARCHITECT Hassell Pty Ltd

BUILDER Hansen Yuncken Pty Ltd

INSTALLER Cladding & Roofing
Contractors Pty Ltd

APPLICATION External Walls

International furniture and homewares retailer, IKEA, completed construction of its distinctive blue and yellow \$40million concept store, just West of Adelaide airport's main gateway, in April 2006.

The 24,000 square metre complex includes many sustainable initiatives such as, water re-use for air-conditioning, packaging compaction, thermal insulating wall panelling and is the benchmark for new IKEA stores world wide.

Paroc panel systems have been used in the construction of many IKEA stores throughout the world and were specified for the Adelaide store as they met the specific design requirement which called for a flat faced, low deflection panel system with wide spanning capabilities.



On this project 5,000m² of panels were used. These were installed both horizontally and vertically with non supported spans of up to 8m between fixings.

These panels met the fire rating requirements as well as providing excellent thermal insulation to the building envelope.

A key feature of this project was the use of rounded vertical corner panels to provide a clean sleek look without visible corner flashings.

Using Bradcore's Paroc panels was instrumental in saving construction time due to their ease of installation and the long span lengths.

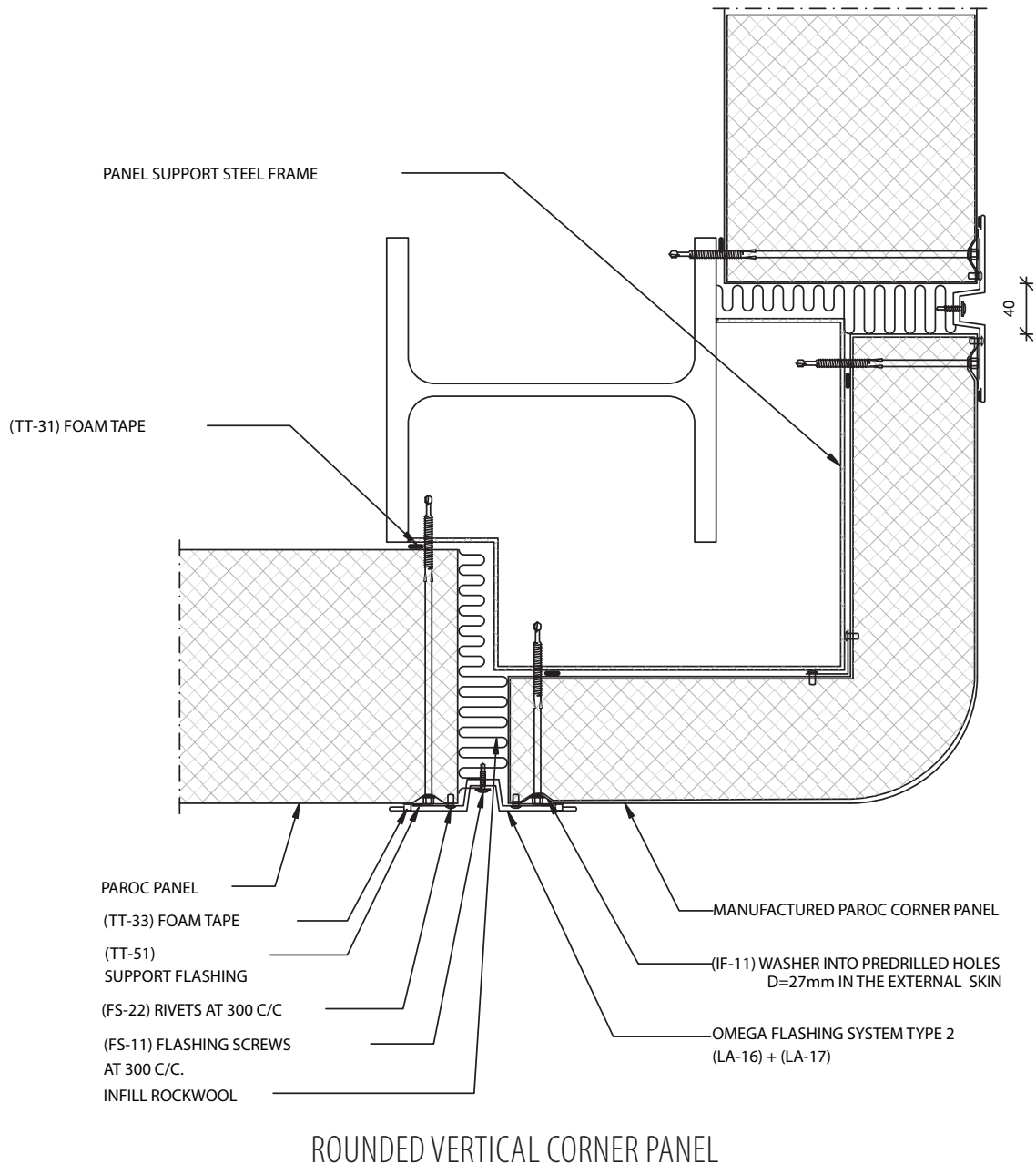

No.PS04

bradcoreTM
panel systems

Free call inside Australia **1800 023 360**
Free call inside New Zealand **0800 227 123**
Email **bradcore@csr.com.au**
www.bradcore.com.au

